

## Allbrox® 6.5 Deep (Portrait and Landscape)

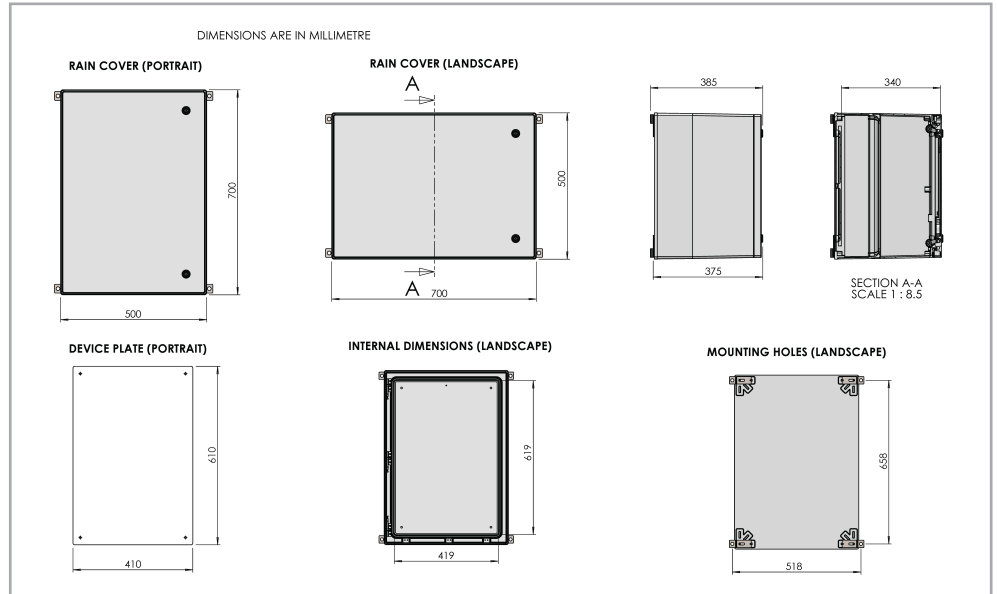

Part Number	Description	H (mm)	W (mm)	D (mm)
ALL-006_5-P/D	Allbrox 6.5 Portrait Deep with SMC Device Plate	700	500	375
ALL-006_5-L/D	Allbrox 6.5 Landscape Deep with SMC Device Plate	500	700	375

- Material: GRP (Glass Reinforced Polyester, SMC (Sheet Moulding Compound))
- IP66
- Non-corrosive
- Non-conductive
- Expected UV life: 25 years +

For any enquiries, please contact us on:

Telephone: +27 (11) 894 8341  
 Fax: +27 (11) 918 1072  
 Email: [sales@allbro.com](mailto:sales@allbro.com)

## Features of Allbrox® 3-6Deep

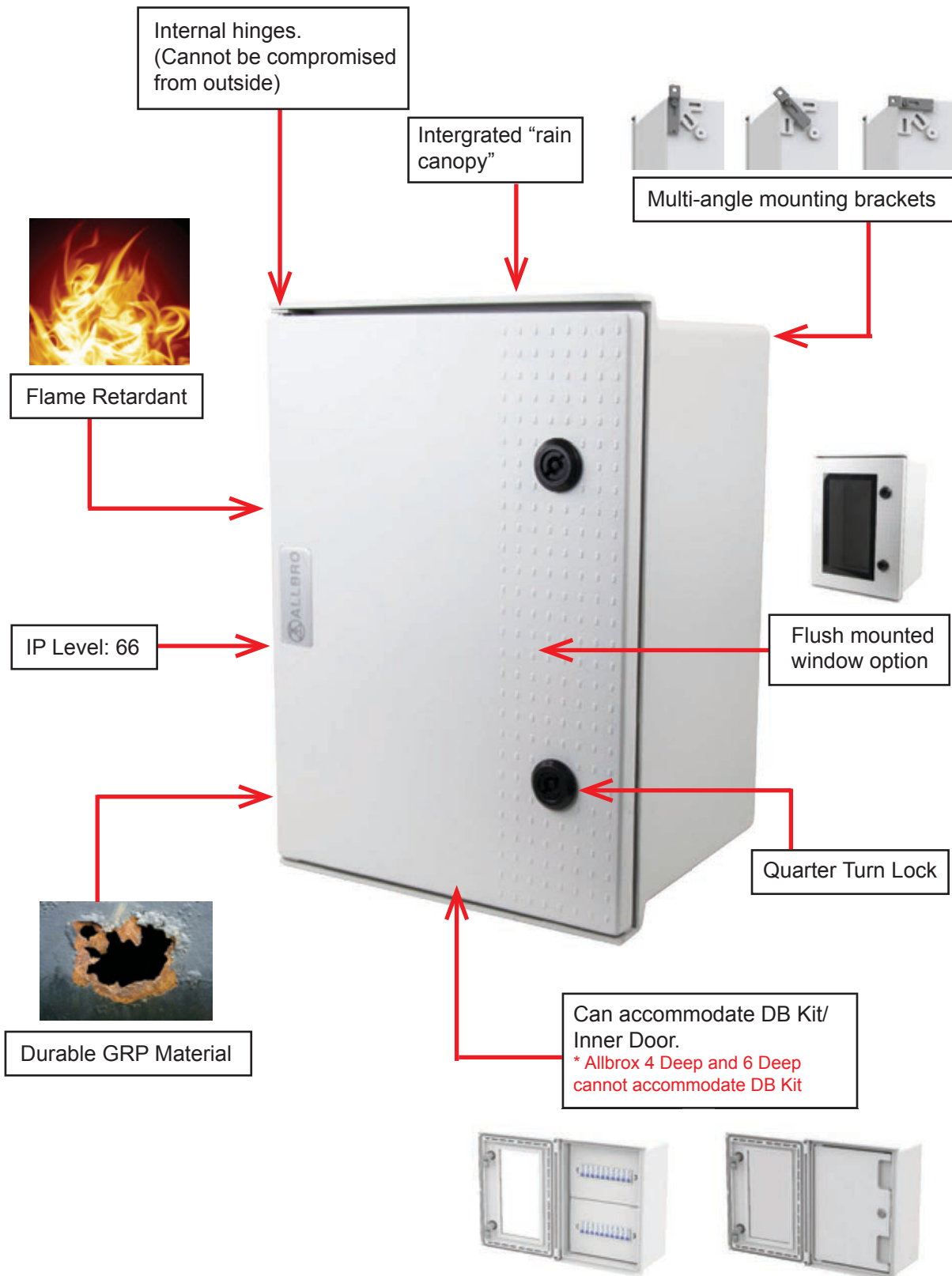

For any enquiries, please contact us on:

Telephone: +27 11 894 8341  
Fax: +27 11 918 1072  
Email: [sales@allbro.com](mailto:sales@allbro.com)

## Material Properties of SMC & DMC

Typical property	standard	units	SMC 1-20	BMC/DMC
Density	ISO 1183	g/ccm	1.8	1.8
Fibre content	EN ISO 1172	mass-%	20	18
Fibre type			Glass	Glass
Recycling code	VDA 260		UP-GS20	UP-GS20
Recyclability	-	-	Yes	Yes
Young's modulus 1)	EN ISO 527-4	GPa	9	13
Tensile strength 1)	EN ISO 527-4	MPa	55	31
Tensile rupture strain 1)	EN ISO 527-4	%	1.4	0.4
Compression strength 1)	EN ISO 14126	MPa	160	160
Poisson's ratio 1)	EN ISO 527-4	-	0.3	0.3
Flex modulus 1)	EN ISO 14125	GPa	10.5	9.5
Flexural strength 1)	EN ISO 14125	MPa	150	90
Impact strength 1)	EN ISO 179	KJ/m <sup>2</sup>	60	30
CTE 1)	ISO 11359-2	10-6m/mK	18	18
Continuous service temperature	Similar to IEC 216	°C	150	150
Short term service temperature	-	°C	210	210
Heat distortion temperature	EN ISO 75-2	°C	200	200
Specific heat capacity	-	J/gK	1.1	1.1
Volume resistivity	IEC 60093	Ohm*cm	10 <sup>12</sup>	10 <sup>7</sup>
Surface resistivity	IEC 60093	Ohm	10 <sup>14</sup>	10 <sup>9</sup>
Comparative tracking index	IEC 60112	CTI	600	600
Dielectric strength	IEC 60243-1	kV/mm	25	25
Dielectric constant	IEC 60250	-	4.5	4.5
Dissipation factor	IEC 60250	-	0.01	0.01
Oxygen index	EN ISO 4589-2	%	22	22
Flammability	UL 94	level/thickness	V0/3.2mm	V0/3.2mm
Flammability	ISO 3795	Class/thickness	NBR/3.2mm	NBR/3.2mm
Fire / smoke	EN 45545	Hazard Level		
Glow bar	IEC 60707	level	BH2-95	BH2-95
Glow wire	IEC 60965-2-1	°C	960	960
Water absorption	ISO 62	% after 24h	<0.3	<0.3

For any enquiries, please contact us on:

Telephone: +27 11 894 8341

Fax: +27 11 918 1072

Email: sales@allbro.com